

LEGEND

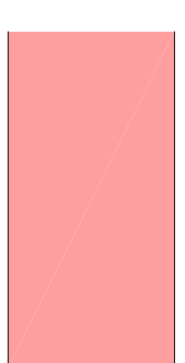

CARRIAGEWAY

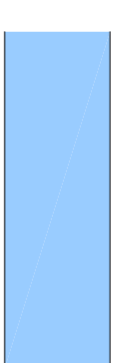

FOOTWAY/FOOTPATH

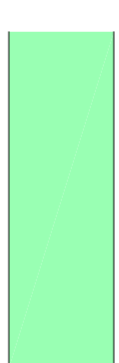

VERGE - TO BE KEPT CLEAR (NOT FOR ADOPTION)

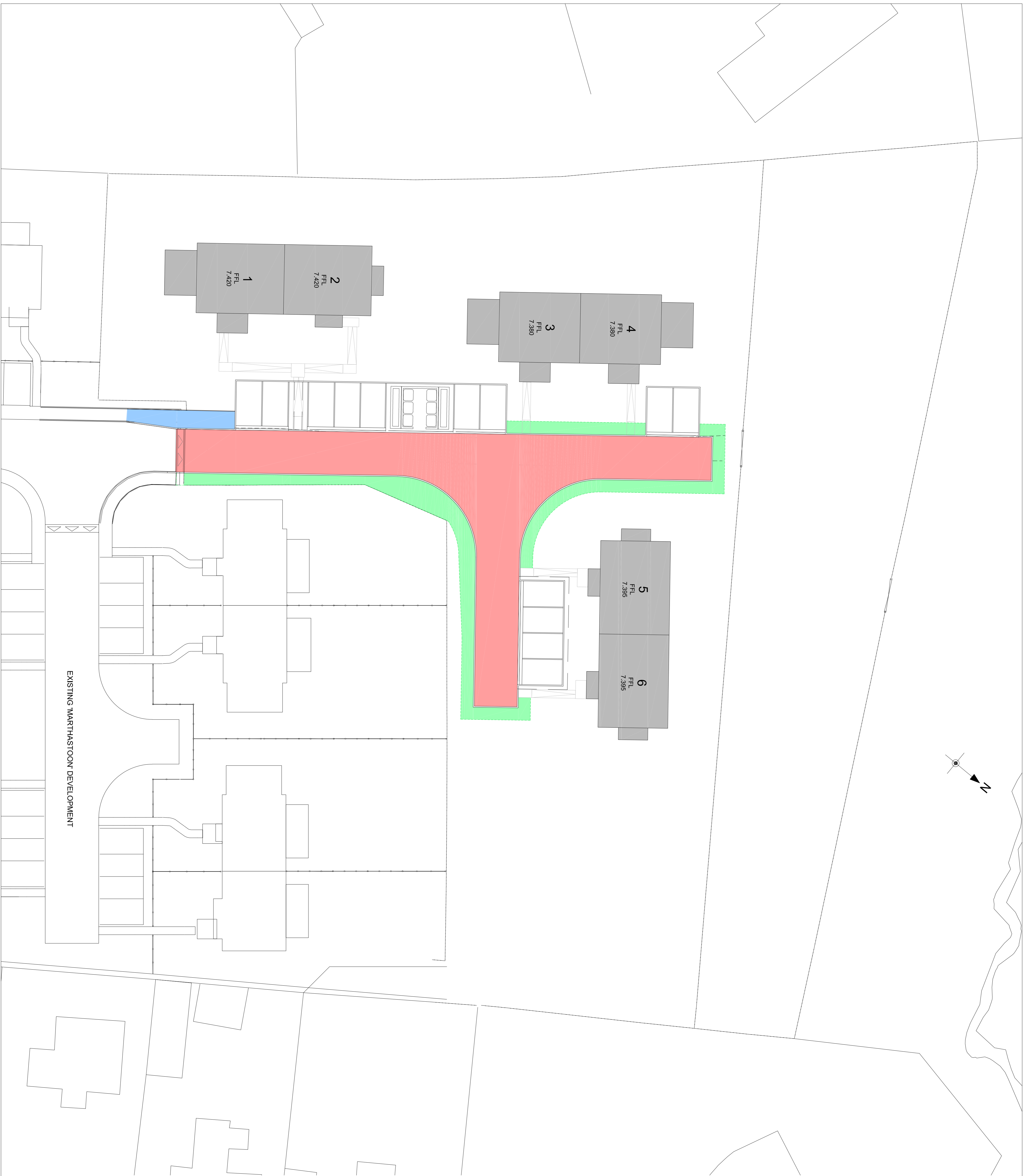
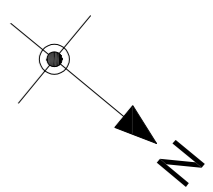

REV	DATE	REVISION	DRN	CHK
-	23/06/2021	Construction Consent Application		

THIS DRAWING IS COPYRIGHT © . DO NOT SCALE FROM THIS DRAWING.

Arch Henderson
1 9 1 9

Chartered Engineers
Structural Engineers
Architects
CMI Chartered
Professional Services
Engineering Services

Stewart Building, Lenwick, Spittal, ZE1 1UL.
Tel: 01955 695512
www.arch-henderson.co.uk • email: lenwick@arch-henderson.co.uk

Address: Dundee, Glasgow, Lewick, Inverness, Thurso, Stromness, Southport, Falkland Islands

PROJECT :
Hjaltland Housing Association
6no. Housing Development, Marthaston, Aith

TITLE :
Construction Consent
Extents of Adoption

DRAWN:	DATE:	CHECKED:	APPROVED:
PRN	Jan 2021	AKT	AKT

SCALE: (A1)
As Shown

DRAWING STATUS: Construction Consent

DRAWING NO.: 182143-A-CC-06

REV: -